

# *SY BONAVENTURA*

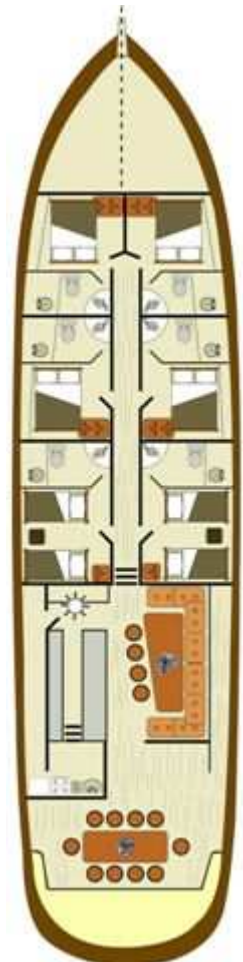

## GENERAL INFORMATION:

**Year..... 2000**  
**Length over all:.....28.50 m (93.48 ft)**  
**Beam:..... 6.80 m (22.3 ft)**  
**Draft:..... 2.90 m (9.51 ft)**  
**Engine:..... .Leland 240HP**  
**Max speed:.....13 knots**  
**Cruising speed:.....9 knots**  
**Fuel tank.....2800 l**  
**Water tank:.....9000 l**  
**Cabins:..... 6**  
**Berths:..... 12+2**  
**Base:.....Dubrovnik**



## ACCOMMODATION & EQUIPMENT:

- 2 cabins with double bed and twin bed in each
- 4 cabins with double beds
- All cabins have en suite bathroom
- Air-conditioning in each cabin
- Large salon in mahogany wood
- Bar with galley
- Ice-maker
- Huge sun deck with 12 sun-bathing mattresses
- Large table on stern deck with teak chairs
- All decks shaded with awnings
- Teak deck
- Deck shower
- Stainless steel guard rail



## LEISURE EQUIPMENT:

- a set of water skis
- 2 doughnuts
- Snorkeling equipment for all guests
- Fishing equipment
- A set of board games.....
- TV, music system
- Computer (laptop with internet connection)
- Big multilingual library (English, French and German)

Yacht is suitable for groups of up to 12 + 2 persons with completely professional services provided on board by a crew of 3. Your vacation on BONAVENTURA begins with a welcome drink on board. Guests will be led to their cabins and the gulet's facilities and safety procedures will be presented before setting sail to discover the stunning Dalmatian coast.

Each morning begins with hot and cold buffet, juice, soft drinks, tea and coffee. While you swim and relax, our chef prepares delicious meals starting from first course and main course to desserts.



# Gulet BONAVENTURA

## Price list 2010

Prices per week in EURO:			
01.01-24.04	24.04-29.05	29.05-26.06	26.06-11.09
16.10-31.12	02.10-16.10	11.09-02.10	
<b>10.700,00</b>	<b>12.500,00</b>	<b>13.200,00</b>	<b>14.300,00</b>

### **OBLIGATORY ADDITIONAL COSTS:**

It is obligatory to take one of the food and beverage options.

### **FOOD OPTIONS:**

-all inclusive full board: 680 EUR/person per week (breakfast, lunch, dinner, all drinks, port taxes and use of all equipment on the yacht, without any extra charge.

-all inclusive half board: 610 EUR/person per week (breakfast, lunch, all drinks, port taxes and use of all equipment on the yacht, without any extra charge.

- super all inclusive menu: 1370 EUR/person per week includes the best Croatian wines, beverages, food and port taxes (shrimps, lobsters, different fish and meat, according to the market offer).

**During day:** fruit, coffee, snacks are served all day long-for free.

**Boat price includes:** boat rental, fuel for 4 hours of cruising per day, the crew, use of all equipment on the yacht.

**The price does not include:** additional meals, National Park entrance fees, special demands for marinas, more than 4 hours of cruising per day (each additional hour is extra charged).